

**ESL of Southwest Michigan**

A program of **kalamazooliteracycouncil**

**420 E. Alcott St., Kalamazoo, MI 49001**

**FREE!**

**Westwood UMC**

ESL classes: Westwood United Methodist Church, 538 Nichols Rd., Kalamazoo, 49006

Time	Monday	Tuesday	Wednesday	Thursday	Friday	
9:00	<b>Goodwill GED</b> 9:00 - 4:30  <b>Goodwill Orientation</b> 2:00-4:00	<b>H</b> ESL Levels 1-2 9:00 - 12:30	ESL Level 1 9:00 - 12:30	ESL Levels 1 9:00 - 10:30	<b>Health Literacy</b> 10:00-11:30   Children 0-4 Monday—Thursday 9:00 a.m.—4:00 p.m. at Goodwill	
9:30		<b>H</b> Open Tutoring 9:00 - 10:30	Open Tutoring 9:00-12:30	ESL Levels 3-4 9:00 - 10:30		
10:00		<b>H</b> ESL Levels 3-4 9:00 - 10:30	<b>H</b> Living in the U.S. 11:00 - 12:30	Parent Literacy 9:00 - 10:30		<b>H</b> Parent Literacy 9:00-10:30
10:30				Conversation 11:00 - 12:30		ESL Levels 3-4 9:00 - 10:30
11:00						Movement 11:00-12:30
11:30						JOBS 11:00 - 12:30
12:00						Book Club 11:00-12:30
12:30			<b>IP</b> ExpressWays Power Hour 12:30 - 1:30	<b>IP</b> Digital Skills L1 11:30 - 12:30		<b>IP</b> ExpressWays Power Hour 12:00 - 1:00
1:00				Open Tutoring (Goodwill) 11:30 - 1:00		
1:30			<b>IP</b> Open Tutoring (Goodwill) 12:30 - 2:00			
2:00						
2:30		<b>IP</b> Digital Skills Level 2 2:00 - 3:00				
3:00						
3:30						
4:00		<b>IP</b> Goodwill GED 9:00-4:30	<b>IP</b> Goodwill GED 9:00-4:30	<b>IP</b> Goodwill GED 9:00 - 4:30		
4:30						
5:00						
5:30						
6:00						
6:30						
7:00	Discussion Group 7:00 to 8:30 <b>V</b>	ESL Levels 2-4 6:30 - 8:00 <b>V</b>	Parent Literacy 7:00 - 8:30 <b>V</b>	ESL Level 1 7:00 - 8:30 <b>V</b>	ESL Levels 2-4 6:30 - 8:00 <b>V</b>	
7:30	Parent Literacy 7:00 - 8:30 <b>V</b>	ESL Level 1 7:00-8:30 <b>V</b>	Parent Literacy 7:00 - 8:30 <b>V</b>	ESL Level 1 7:00 - 8:30 <b>V</b>		

**IP** Call **Tameca** at 269-382-0490 ext.253 or email [tblack@kalamazooliteracy.org](mailto:tblack@kalamazooliteracy.org)

**H** Call **Kamaria** at 269-382-0490 ext. 263 or email [knichols@kalamazooliteracy.org](mailto:knichols@kalamazooliteracy.org)

**ESL** Call **Lupita** at 269-382-0490 ext. 224 or email [gflores@kalamazooliteracy.org](mailto:gflores@kalamazooliteracy.org)

**GED** Call **Kym** at 269-382-0490 ext. 287 or email [khollars@goodwillswmi.org](mailto:khollars@goodwillswmi.org)

**IP** IN-PERSON  
**H** HYBRID (BOTH)  
**V** VIRTUAL

# ADULT EDUCATION AND TRAINING

Goodwill Industries of Southwestern Michigan  
420 E. Alcott Street Kalamazoo, MI 49001

## OUR CAMPUS

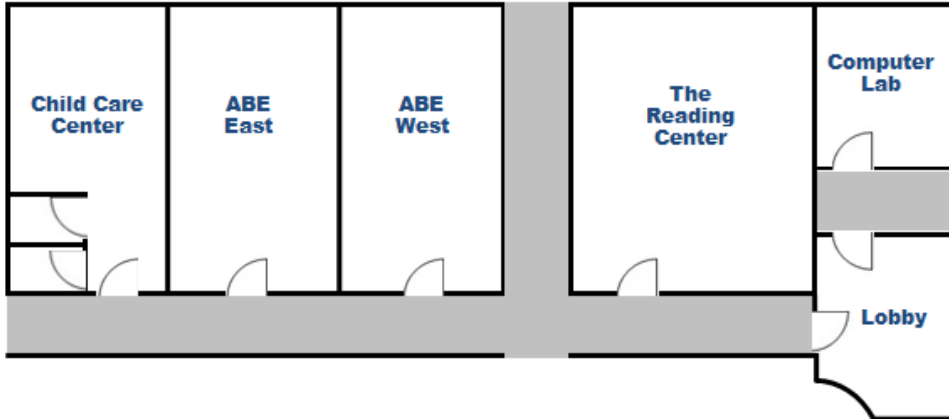

## OUR FACULTY

### Kym Hollars

Adult Education and Training Manager

### Brian Kincaid

Adult Education Instructor

### Laura McCoy

Adult Education Instructor

### Lupita Flores

ESL Adult Learning Services Navigator

### Tameca Black

ABE Adult Learning Services Navigator

### William Johnson

Reading Center Coordinator

### Kamaria Snell

Parent Literacy Navigator

### Mike List

Early Learning Support Specialist

## VISIT US AT

[www.goodwillswmi.org](http://www.goodwillswmi.org)  
[www.kalamazooliteracy.org](http://www.kalamazooliteracy.org)

# ADULT EDUCATION AND TRAINING

Goodwill Industries of Southwestern Michigan  
420 E. Alcott Street Kalamazoo, MI 49001

*Free classes to help you reach your goals!*

- GED Preparation
- Adult Basic Education
- Employment Skills
- Digital Literacy
- English as a Second Language
- Financial Literacy
- Health Literacy
- Parent Literacy
- Tutoring Services
- Navigation Services

*Your pathway to  
success begins  
here!*

## CONTINUE LEARNING

## PARTNERS IN ADULT LEARNING



Kalamazoo Public Schools

KALAMAZOO ADULT EDUCATION

